

CHECK VALVES

O-CHECK®

SERIES CV

Lightweight aluminum O-Check® features a dilating O-ring as the only moving part. Quick to open, quick to close, O-Check 'out-flows' the competition, will last millions of cycles (factory tests to 50 million cycles show no discernible wear) and always provides positive sealing (no bubble leakage). Standard NPTF sizes $1/8''$, $1/4''$, $3/8''$, $1/2''$ and $3/4''$.

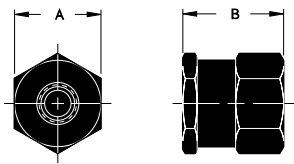
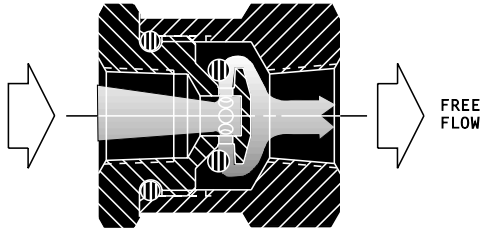
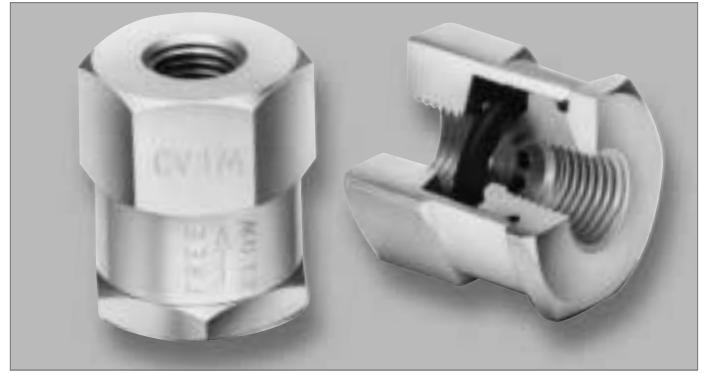

Model No.	Pipe Thread	A	B
CV- $1/8$	$1/8$ -27	$3/4$	$15/16$
CV- $1/4$	$1/4$ -18	$1 1/8$	$1 5/16$
CV- $3/8$	$3/8$ -18	$1 1/8$	$1 5/16$
CV- $1/2$	$1/2$ -14	$1 5/8$	$1 9/16$
CV- $3/4$	$3/4$ -14	$1 7/8$	$2 2/16$

FLOW CONTROLS

RIGHT ANGLE FLOW CONTROL

SERIES RFC

Flairline right angle flow controls incorporate O-Check as the bypass valve. RFC permits full free flow in one direction, accurately metered flow in opposite direction. Standard metering needle design includes compound needle taper of 5° and 15° and fine adjustment stem threads (RFC $1/4$ for example is $1/4''$ -36). Right angle design eliminates the need for pipe ell normally used to make 90° turn at cylinder port. Standard NPTF sizes $1/8''$, $1/4''$, $3/8''$, $1/2''$ and $3/4''$. Adjustment knobs and panel mounting available (NPTF sizes $1/8''$, $1/4''$ and $3/8''$ only). Optional swivel connector allows "direct" cylinder mounting and 360° rotation for ease of installation and space saving (NPTF sizes $1/8''$, $1/4''$, $3/8''$, and $1/2''$ only).

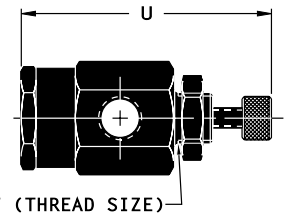
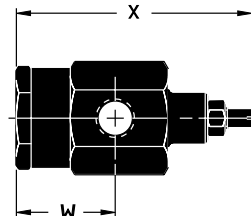
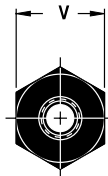
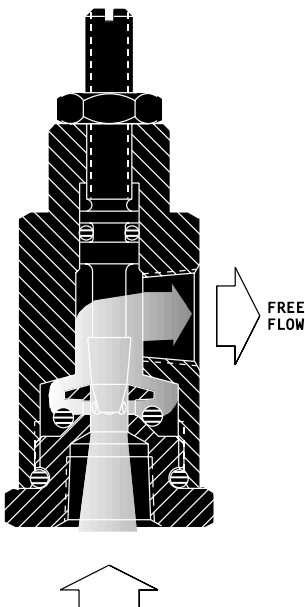
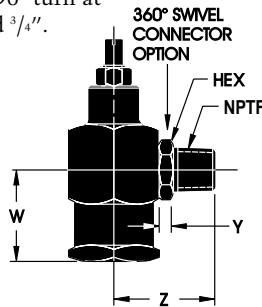

Right Angle Flow Control Model RFC-(NPTF)								
NPTF	T	U	V	W	X	Y	Z	HEX
$1/8$	$1/2$ -20	$2 7/16$	$3/4$	$7/8$	$2 1/8$.13	.91	$1/2$
$1/4$	$5/8$ -18	$3 3/16$	$1 1/4$	$1 1/4$	3	.15	1.34	$3/4$
$3/8$	$5/8$ -18	$3 3/16$	$1 1/4$	$1 1/4$	3	.15	1.34	$3/4$
$1/2$			$1 5/8$	$1 5/8$	$3 3/4$.28	1.84	$7/8$
$3/4$			2	$1 1/4$	$3 3/4$			

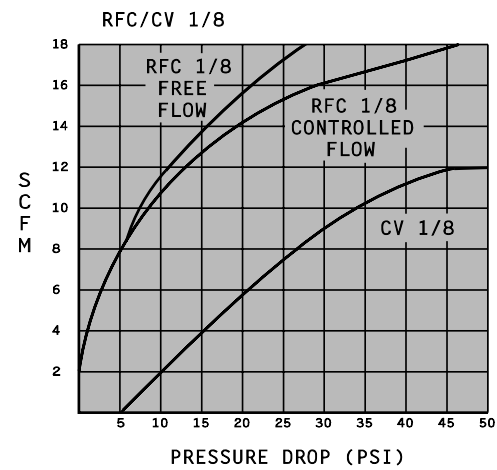
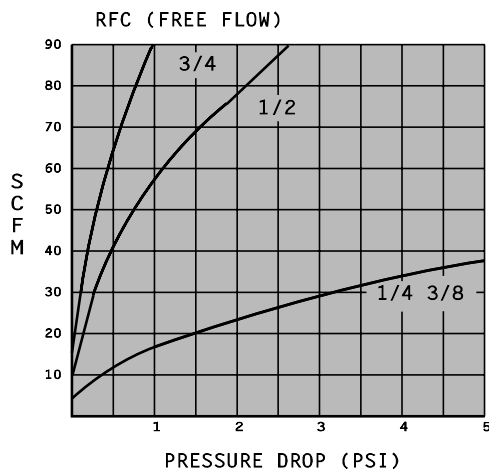
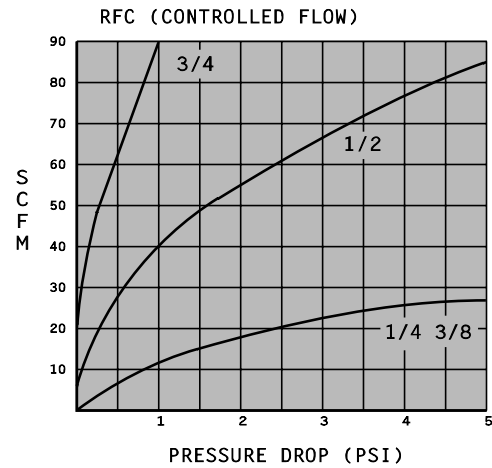
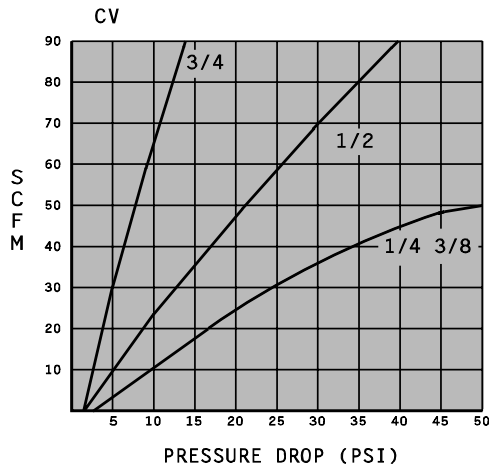

SPECIFICATIONS

Operating Pressure: 250 psi
 Operating Temperature Range: -40° - +225°F.
 Standard O-Ring Material: Buna-N (Viton available on 1/8", 1/4" and 3/8" NPTF models)
 Standard Valve Body Material: Aluminum
 Standard Needle Material: Brass
 Standard Swivel Connector Material: Zinc-Plated Steel

FEATURES

- Flairline Valves' compact design add to the appearance of any type of equipment.
- All Flairline Valves are individually tested before they leave the factory.
- Tests up to 50 million cycles show no discernible wear and still perform "bubble-tite."

ORDERING INSTRUCTIONS

EXAMPLE:

SERIES	CODE	NPTF	OPTIONS	CODE	O-RINGS	CODE
O-Check	CV	1/8 to 3/8			Buna-N (Standard) Viton	V
		1/2 and 3/4			Buna-N (Only)	
Right Angle Flow Control	RFC	1/8 to 3/8	Knob Panel Mount Knob & Panel Mt. Swivel Swivel & Knob	K P PK S SK	Buna-N (Standard) Viton	V
		1/2	Swivel	S	Buna-N (Only)	
		3/4				

All specifications and dimensions are subject to change without notice.