

Features: Tube Markers

- Snap on/off before or after tubing is connected
- Will not pinch, kink, or mar tubing
- Hot stamped and imprinted black coding on white background
- Kits available

Specifications

Tube Size						
1/8 OD	5/32 OD	1/4 OD	3/8 OD	Imprint	Pkg	
Part Number(s)						
TM2-0	TM1-0	TM4-0	TM6-0	0	50	
TM2-1	TM1-1	TM4-1	TM6-1	1	50	
TM2-2	TM1-2	TM4-2	TM6-2	2	50	
TM2-3	TM1-3	TM4-3	TM6-3	3	50	
TM2-4	TM1-4	TM4-4	TM6-4	4	50	
TM2-5	TM1-5	TM4-5	TM6-5	5	50	
TM2-6	TM1-6	TM4-6	TM6-6	6	50	
TM2-7	TM1-7	TM4-7	TM6-7	7	50	
TM2-8	TM1-8	TM4-8	TM6-8	8	50	
TM2-9	TM1-9	TM4-9	TM6-9	9	50	
TM2-A	TM1-A	TM4-A	TM6-A	A	50	
TM2-B	TM1-B	TM4-B	TM6-B	B	50	
TM2-C	TM1-C	TM4-C	TM6-C	C	50	
TM2-D	TM1-D	TM4-D	TM6-D	D	50	
TM2-E	TM1-E	TM4-E	TM6-E	E	50	
TM2-F	TM1-F	TM4-F	TM6-F	F	50	
TM2-G	TM1-G	TM4-G	TM6-G	G	50	
TM2-H	TM1-H	TM4-H	TM6-H	H	50	
TM2-J	TM1-J	TM4-J	TM6-J	J	50	
TM2-P	TM1-P	TM4-P	TM6-P	P	50	
TM2-R	TM1-R	TM4-R	TM6-R	R	50	
TM2-X	TM1-X	TM4-X	TM6-X	X	50	
TM2-Y	TM1-Y	TM4-Y	TM6-Y	Y	50	
TM2-Z	TM1-Z	TM4-Z	TM6-Z	Z	50	
TM2-KIT2	TM1-KIT2	TM4-KIT2	TM6-KIT2	Alpha/Numeric	1	
TM2-CYL	TM1-CYL	TM4-CYL	TM6-CYL	CYL (cylinder)	50	
TM2-PV	TM1-PV	TM4-PV	TM6-PV	PV (power valve)	50	
TM2-LV	TM1-LV	TM4-LV	TM6-LV	LV (limit valve)	50	
TM2-IN	TM1-IN	TM4-IN	TM6-IN	IN (input)	50	
TM2-OUT	TM1-OUT	TM4-OUT	TM6-OUT	OUT (output)	50	
TM2-+	TM1-+	TM4-+	TM6-+	+ (extend)	50	
TM2--	TM1--	TM4--	TM6--	- (retract)	50	
TM2-KIT3	TM1-KIT3	TM4-KIT3	TM6-KIT3	Legend/Code	1	

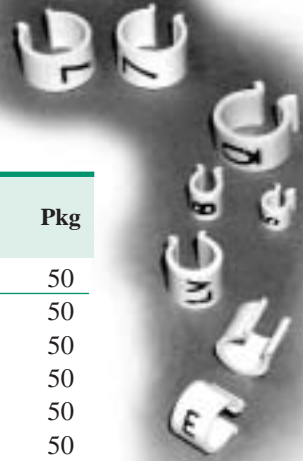

Refer to next page for ordering information.

Features: Tube T-Clips

- Precision injection molded acetal plastic
- Provide quick, secure mounting with exact spacing between tubes
- Center mounting hole for convenience

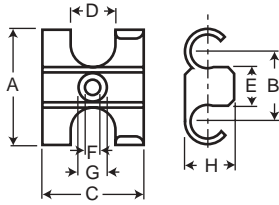

Specifications

Part Number	Tube Size	A	B	C	D	E	F	G	H	Pkg
PCT-4-2	5/32	.59	.39	.71	.24	.28	.116	.236	.35	50
PCT-6-2	1/4	.79	.47	.79	.31	.31	.118	.236	.35	50
PCT-8-2	5/16	.98	.59	.95	.39	.39	.157	.314	.47	50
PCT-10-2	3/8	1.18	.71	1.10	.47	.43	.157	.314	.59	50
PCT-12-2	1/2	1.34	.83	1.38	.55	.47	.157	.354	.67	50
PCT-15-2	5/8	1.69	.98	1.65	.67	.55	.196	.393	.79	50
PCT-18-2	3/4	1.97	1.22	1.93	.79	.63	.196	.472	.91	25
PCT-22-2	7/8	2.56	1.54	2.48	.98	.83	.275	.511	1.14	25

Measurements in inches unless otherwise noted

Ordering Information

Tube T-Clips

- Tube T-Clips are sold in package quantities, please refer to Specifications information for availability.
- Contact factory for custom configurations.

Ordering Information

Tube Markers

- Tube markers are sold in package quantities (50 pcs).
- Tube marker kits:
KIT2 contains 50 of each Alpha/Numeric marker.
KIT3 contains 50 of each Legend/Code marker.



Features: Tube Racks

- Route and secure multiple tubing lines
- Mounting versatility:
 - Adhesive fastener available on 5/32, 3/16 and 1/4
 - Thru holes provided (all sizes)



5/32" OD, 3/16" OD, and 1/4" OD tube racks can be easily hand separated down to single holders.

Specifications

Product Group	Tubing OD	Description	Standard Colors Available	No. of Channels
PCTR156-102	5/32	non-adhesive	2	10
PCTR156-112	5/32	adhesive	2	10
PCTR187-102	3/16	non-adhesive	2	10
PCTR187-112	3/16	adhesive	2	10
PCTR250-10*	1/4	non-adhesive	2, 3, 4, 5, 6, 7, 8 & 9	10
PCTR250-11*	1/4	adhesive	2, 3, 4, 5, 6, 7, 8 & 9	10
PCTR375-102	3/8	non-adhesive	2	7
PCTR500-102	1/2	non-adhesive	2	5

Ordering Information

Tube Racks

- Tube racks are sold in packages quantities of 10.
- Select color, by code, and replace the "*" in the part number with the code number- all colors subject to availability.
- Contact factory for custom color orders.

Standard Color Code*

2= black	6= yellow
3= red	7= orange
4= blue	8= gray
5= green	9= white

Please note: mounting screws not provided

Features: Nylon Hose Clamps

- FDA approved for medical and food applications
- Will not rust or corrode
- Ratchet/Lock style;
may be installed while hose is connected



Ordering Information

Part No.	Clamp Max. Diam.	Clamp Min. Diam.	Pkg
PCHCP-0250	.290	.246	100
PCHCP-0344	.406	.360	100
PCHCP-0406	.468	.410	100
PCHCP-0468	.536	.475	100
PCHCP-0531	.608	.538	100
PCHCP-0593	.665	.597	100

Nylon Hose Clamps

- Nylon hose clamps are sold in packages of 100.
- Contact factory for stainless steel hose clamps.
- Contact factory for custom quantity orders.

Features: Tube Harness Coil

- Polyethylene wrap for bundling tubing or wires
- May be installed while tubing is connected



Ordering Information

Part No.	Bundle OD Diam.	Pkg ft
PCTH125-0	1/16 to 1/2	100
PCTH125-0-R	1/16 to 1/2	500
PCTH250-0	3/16 to 1	100
PCTH250-0-R	3/16 to 1	500
PCTH375-0	1/4 to 2	50
PCTH375-0-R	1/4 to 2	250
PCTH500-0	3/8 to 4	25
PCTH500-0-R	3/8 to 4	250

Tube Harness Coil

- Tube harness coils are sold in package quantities.
- Standard color is natural Polyethylene, black is available on special order.
- Contact factory for custom quantity orders.

Features: Tube Cutter

■ Precision cutter makes quick, clean and square cuts on all plastic tubing material



Ordering Information

Part No.	Description	Pkg
PCTC-1000	Tube Cutter	1
PCRB-1000	Replacement blade	5

Tube Cutter

■ Tube cutters and replacement blades are sold separately.

Features: Jacket Trimming Tool

■ Trim jacketing for fitting connection with conventional compression or push-in fittings
 ■ Allows easy jacket removal without touching inner tubing



Ordering Information

Part No.	Description	Pkg
PCJTT-1	Trimming tool	1
PCJRB	Replacement blade	10

Jacket Trimming Tool

■ Jacket trimming tool and replacement blades are sold separately.

For use with Weld Spatter Tubing refer to page 87 (metric sizes page 125)